

# GN 7490

Welded sockets

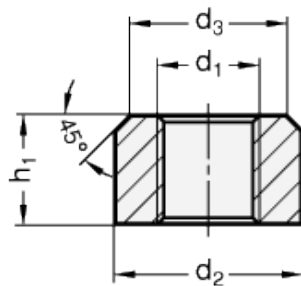

Type A



Type B

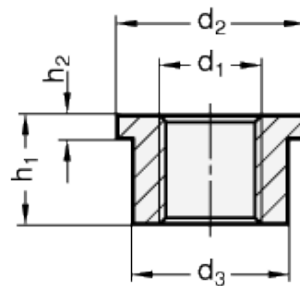

Example of application

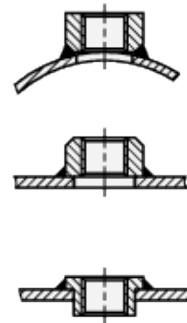

## technical informations

### Material

Steel, turned, blank, weldable.

### Standard versions available

- Type A: with chamfer.
- Type B: with collar.

### Special executions on request (For sufficient quantities)

- Welding sockets in Stainless Steel
- metric threads

### Features and applications

Welding sockets GN 7490 are used in container construction or in hydraulics for mounting instruments such as oil level sight glasses or locking caps. The plane surfaces are machined, with the effect that they can be used as sealing surface in connection with a sealing element or compound.

The favourably dimensioned wall thickness prevents deformation or burn-through during welding.  
 Type B is used if exact positioning through the mounting borfe or a low construction height is required.

Standard Elements	Main Dimensions					Weight
	Description	d <sub>1</sub>	d <sub>2</sub>	d <sub>3</sub>	h <sub>1</sub>	
GN 7490-ST-G1/8-A	G1/8	20	16	10	3	18
GN 7490-ST-G1/4-A	G1/4	24	20	14	3	35
GN 7490-ST-G3/8-A	G3/8	28	22	14	4.5	42
GN 7490-ST-G1/2-A	G1/2	32	26	16	4.5	57
GN 7490-ST-G3/4-A	G3/4	40	32	18	6	97
GN 7490-ST-G1-A	G1	50	40	20	7.5	165
GN 7490-ST-G11/4-A	G11/4	60	50	22	7.5	244
GN 7490-ST-G11/2-A	G11/2	65	55	24	7.5	282
GN 7490-ST-G1/8-B	G1/8	20	16	10	3	13
GN 7490-ST-G1/4-B	G1/4	24	20	14	3	24
GN 7490-ST-G3/8-B	G3/8	28	22	14	4.5	28
GN 7490-ST-G1/2-B	G1/2	32	26	16	4.5	36
GN 7490-ST-G1-B	G1	50	40	20	7.5	111
GN 7490-ST-G3/4-B	G3/4	40	32	18	6	61
GN 7490-ST-G11/4-B	G11/4	60	50	22	7.5	162
GN 7490-ST-G11/2-B	G11/2	65	55	24	7.5	177



STANDARD MACHINE ELEMENTS WORLDWIDE