

## Magnetic catches with rubberised magnetic surface

### SPECIFICATION

#### Types

- Type **A1**: Magnetic surface top, with bore
- Type **A2**: Magnetic surface top, with slotted hole
- Type **C1**: Magnetic surface laterally, with bore
- Type **C2**: Magnetic surface laterally, with slotted hole

#### Identification no.

- Version **W**: without contact plate
- Version **F**: with contact plate, with countersunk hole
- Version **L2**: with contact plate, L-profile, with slotted hole
- Version **L3**: with contact plate, L-profile, with slotted hole, elongated
- Version **Z2**: with contact plate, Z-profile, with slotted hole
- Version **Z3**: with contact plate, Z-profile, with slotted hole, elongated

Zinc die casting

Plastic coated

black, RAL 9005, textured finish **SW**

silver, RAL 9006, textured finish **SR**

Material of the magnet

NdFeB

Neodymium, iron, boron

temperature resistant up to 80 °C

Rubber cap (magnetic surface)

Elastomer (TPE), black

Hardness ≈ 80 Shore A

Contact plate

Steel

zinc plated, blue passivated

### INFORMATION

Magnetic catches GN 4470 are compact parts that hold covers, doors and sliding doors closed. The rubberised magnetic surface reduces noise and prevents damage to the opposite part.

The contact plates for diverse installation situations expand the possible range of applications and are used, for example, when magnetic catches are desired but the opposite part is non-magnetic. For magnetic catches of types A1 and A2, full-surface contact in the area of the locking plate must be ensured during installation.

### ON REQUEST

- further finishes
- other magnetic surfaces
- Contact plates with other dimensions
- Contact plates with other shapes
- Contact plates with other finishes

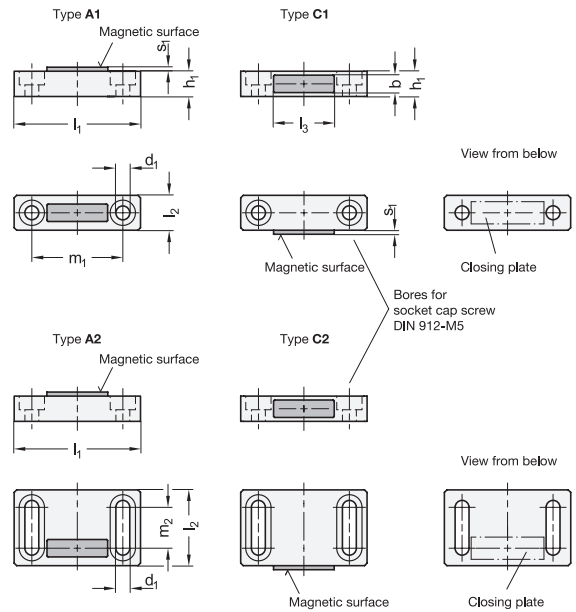
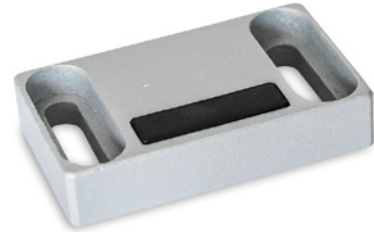

Identification **F**

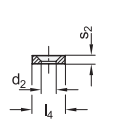

Identification **L2 / L3**

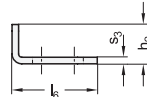

Identification **Z2 / Z3**

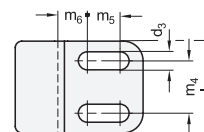
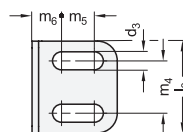
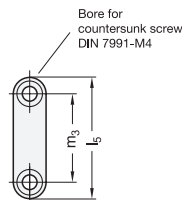
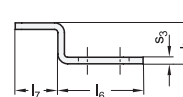

### GN 4470-A1

Description	l1	b	d1	d2	d3	h1	h2	h3	l2	l3	l4	l5	l6	l7	l8	m1	m3	m4	m5	m6	s1	s2	s3	Nominal magnetic forces in N	
GN 4470-50-A1-F-SR	50	7	5.5	4.5	-	10	-	-	12	24	10	40	-	-	-	38	30	-	-	-	0.5	2.5	-	30	35
GN 4470-50-A1-F-SW	50	7	5.5	4.5	-	10	-	-	12	24	10	40	-	-	-	38	30	-	-	-	0.5	2.5	-	30	35
GN 4470-50-A1-L2-SR	50	7	5.5	-	5.5	10	12	-	12	24	-	-	26	-	28	38	-	16	10	9	0.5	-	2	30	42
GN 4470-50-A1-L2-SW	50	7	5.5	-	5.5	10	12	-	12	24	-	-	26	-	28	38	-	16	10	9	0.5	-	2	30	42
GN 4470-50-A1-L3-SR	50	7	5.5	-	5.5	10	12	-	12	24	-	-	38	-	28	38	-	16	14	15	0.5	-	2	30	46
GN 4470-50-A1-L3-SW	50	7	5.5	-	5.5	10	12	-	12	24	-	-	38	-	28	38	-	16	14	15	0.5	-	2	30	46
GN 4470-50-A1-W-SR	50	7	5.5	-	-	10	-	-	12	24	-	-	-	-	-	38	-	-	-	-	0.5	-	-	30	29
GN 4470-50-A1-W-SW	50	7	5.5	-	-	10	-	-	12	24	-	-	-	-	-	38	-	-	-	-	0.5	-	-	30	29
GN 4470-50-A1-Z2-SR	50	7	5.5	-	5.5	10	-	12.5	12	24	-	-	26	13	28	38	-	16	10	9	0.5	-	2	30	47
GN 4470-50-A1-Z2-SW	50	7	5.5	-	5.5	10	-	12.5	12	24	-	-	26	13	28	38	-	16	10	9	0.5	-	2	30	47
GN 4470-50-A1-Z3-SR	50	7	5.5	-	5.5	10	-	12.5	12	24	-	-	38	13	28	38	-	16	14	15	0.5	-	2	30	52
GN 4470-50-A1-Z3-SW	50	7	5.5	-	5.5	10	-	12.5	12	24	-	-	38	13	28	38	-	16	14	15	0.5	-	2	30	52

### GN 4470-A2

Description	l1	b	d1	d2	d3	h1	h2	h3	l2	l3	l4	l5	l6	l7	l8	m2	m3	m4	m5	m6	s1	s2	s3	Nominal magnetic forces in N	
GN 4470-50-A2-F-SR	50	7	5.5	4.5	-	10	-	-	30	24	10	40	-	-	-	18	30	-	-	-	0.5	2.5	-	30	60
GN 4470-50-A2-F-SW	50	7	5.5	4.5	-	10	-	-	30	24	10	40	-	-	-	18	30	-	-	-	0.5	2.5	-	30	60
GN 4470-50-A2-L2-SR	50	7	5.5	-	5.5	10	12	-	30	24	-	-	26	-	28	18	-	16	10	9	0.5	-	2	30	67
GN 4470-50-A2-L2-SW	50	7	5.5	-	5.5	10	12	-	30	24	-	-	26	-	28	18	-	16	10	9	0.5	-	2	30	67
GN 4470-50-A2-L3-SR	50	7	5.5	-	5.5	10	12	-	30	24	-	-	38	-	28	18	-	16	14	15	0.5	-	2	30	71
GN 4470-50-A2-L3-SW	50	7	5.5	-	5.5	10	12	-	30	24	-	-	38	-	28	18	-	16	14	15	0.5	-	2	30	71
GN 4470-50-A2-W-SR	50	7	5.5	-	-	10	-	-	30	24	-	-	-	-	-	18	-	-	-	-	0.5	-	-	30	54
GN 4470-50-A2-W-SW	50	7	5.5	-	-	10	-	-	30	24	-	-	-	-	-	18	-	-	-	-	0.5	-	-	30	54
GN 4470-50-A2-Z2-SR	50	7	5.5	-	5.5	10	-	12.5	30	24	-	-	26	13	28	18	-	16	10	9	0.5	-	2	30	72
GN 4470-50-A2-Z2-SW	50	7	5.5	-	5.5	10	-	12.5	30	24	-	-	26	13	28	18	-	16	10	9	0.5	-	2	30	72
GN 4470-50-A2-Z3-SR	50	7	5.5	-	5.5	10	-	12.5	30	24	-	-	38	13	28	18	-	16	14	15	0.5	-	2	30	77
GN 4470-50-A2-Z3-SW	50	7	5.5	-	5.5	10	-	12.5	30	24	-	-	38	13	28	18	-	16	14	15	0.5	-	2	30	77

### GN 4470-C1

Description	l1	b	d1	d2	d3	h1	h2	h3	l2	l3	l4	l5	l6	l7	l8	m1	m3	m4	m5	m6	s1	s2	s3	Nominal magnetic forces in N	
GN 4470-50-C1-F-SR	50	7	5.5	4.5	-	10	-	-	12	24	10	40	-	-	-	38	30	-	-	-	0.5	2.5	-	30	35
GN 4470-50-C1-F-SW	50	7	5.5	4.5	-	10	-	-	12	24	10	40	-	-	-	38	30	-	-	-	0.5	2.5	-	30	35
GN 4470-50-C1-L2-SR	50	7	5.5	-	5.5	10	12	-	12	24	-	-	26	-	28	38	-	16	10	9	0.5	-	2	30	42
GN 4470-50-C1-L2-SW	50	7	5.5	-	5.5	10	12	-	12	24	-	-	26	-	28	38	-	16	10	9	0.5	-	2	30	42
GN 4470-50-C1-L3-SR	50	7	5.5	-	5.5	10	12	-	12	24	-	-	38	-	28	38	-	16	14	15	0.5	-	2	30	46
GN 4470-50-C1-L3-SW	50	7	5.5	-	5.5	10	12	-	12	24	-	-	38	-	28	38	-	16	14	15	0.5	-	2	30	46
GN 4470-50-C1-W-SR	50	7	5.5	-	-	10	-	-	12	24	-	-	-	-	-	38	-	-	-	-	0.5	-	-	30	29
GN 4470-50-C1-W-SW	50	7	5.5	-	-	10	-	-	12	24	-	-	-	-	-	38	-	-	-	-	0.5	-	-	30	29
GN 4470-50-C1-Z2-SR	50	7	5.5	-	5.5	10	-	12.5	12	24	-	-	26	13	28	38	-	16	10	9	0.5	-	2	30	47
GN 4470-50-C1-Z2-SW	50	7	5.5	-	5.5	10	-	12.5	12	24	-	-	26	13	28	38	-	16	10	9	0.5	-	2	30	47
GN 4470-50-C1-Z3-SR	50	7	5.5	-	5.5	10	-	12.5	12	24	-	-	38	13	28	38	-	16	14	15	0.5	-	2	30	52
GN 4470-50-C1-Z3-SW	50	7	5.5	-	5.5	10	-	12.5	12	24	-	-	38	13	28	38	-	16	14	15	0.5	-	2	30	52

### GN 4470-C2

Description	l1	b	d1	d2	d3	h1	h2	h3	l2	l3	l4	l5	l6	l7	l8	m2	m3	m4	m5	m6	s1	s2	s3	Nominal magnetic forces in N	
GN 4470-50-C2-F-SR	50	7	5.5	4.5	-	10	-	-	30	24	10	40	-	-	-	18	30	-	-	-	0.5	2.5	-	30	60
GN 4470-50-C2-F-SW	50	7	5.5	4.5	-	10	-	-	30	24	10	40	-	-	-	18	30	-	-	-	0.5	2.5	-	30	60
GN 4470-50-C2-L2-SR	50	7	5.5	-	5.5	10	12	-	30	24	-	-	26	-	28	18	-	16	10	9	0.5	-	2	30	67
GN 4470-50-C2-L2-SW	50	7	5.5	-	5.5	10	12	-	30	24	-	-	26	-	28	18	-	16	10	9	0.5	-	2	30	67
GN 4470-50-C2-L3-SR	50	7	5.5	-	5.5	10	12	-	30	24	-	-	38	-	28	18	-	16	14	15	0.5	-	2	30	71
GN 4470-50-C2-L3-SW	50	7	5.5	-	5.5	10	12	-	30	24	-	-	38	-	28	18	-	16	14	15	0.5	-	2	30	71
GN 4470-50-C2-W-SR	50	7	5.5	-	-	10	-	-	30	24	-	-	-	-	-	18	-	-	-	-	0.5	-	-	30	54
GN 4470-50-C2-W-SW	50	7	5.5	-	-	10	-	-	30	24	-	-	-	-	-	18	-	-	-	-	0.5	-	-	30	54
GN 4470-50-C2-Z2-SR	50	7	5.5	-	5.5	10	-	12.5	30	24	-	-	26	13	28	18	-	16	10	9	0.5	-	2	30	72
GN 4470-50-C2-Z2-SW	50	7	5.5	-	5.5	10	-	12.5	30	24	-	-	26	13	28	18	-	16	10	9	0.5	-	2	30	72
GN 4470-50-C2-Z3-SR	50	7	5.5	-	5.5	10	-	12.5	30	24	-	-	38	13	28	18	-	16	14	15	0.5	-	2	30	77
GN 4470-50-C2-Z3-SW	50	7	5.5	-	5.5	10	-	12.5	30	24	-	-	38	13	28	18	-	16	14	15	0.5	-	2	30	77



### APPLICATION EXAMPLES

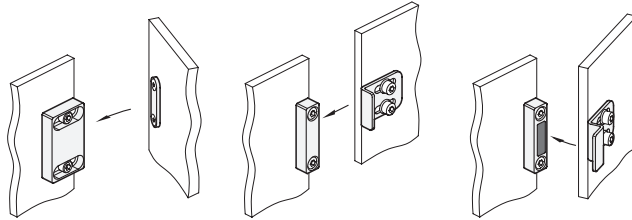

### POSSIBLE COMBINATIONS MAGNETIC CATCH - CONTACT PLATE

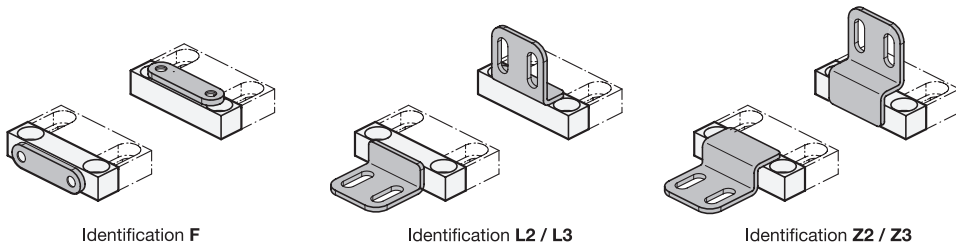

### USE ON PROFILE SYSTEMS

Grid dimension of the profile system	Magnetic catches with contact plate				
Type - Identification					
A1 - L ...	A1 - L ...	A1 - L ...	A2 - Z ...	C2 - F	C2 - L ...
-	Surface-mounted door	Surface-mounted door - Countersunk magnet	Inset door	Surface-mounted door	Sliding door
20	-	L2	Z2, s = 0 ... 10 mm	F	L2, s = 0 ... 10 mm
30	-	L2	Z3, s = 0 ... 15 mm	F	L3, s = 0 ... 15 mm
40	L2	L2	Z3, s = 0 ... 10 mm	F	L3, s = 0 ... 10 mm
45	L2	L2	Z3, s = 0 ... 7 mm	F	L3, s = 0 ... 7 mm

